



Closing conveyor HTA-15S

Closing



Slicing



Packaging



Sereral



Special



Fully-automatic packaging line with a clipband closing system. To combine with a bread slicer for a semi-automatic line or to combine with a Bagloader HBS system or behind a flow packer for a fully-automatic line. Horizontal or inclined, various lengths available.

The continuous working packing line can be used as a semi-automatic machine by packing with a Bagblower type HBB for easy opening of the bag or in a fully-automatic line combined with a Bagloader type HBS machine. This system is completely constructed to the customer requirements from a basic design and many variations can therefore be delivered. This high quality machine with its hardened components and grinded shafts, is also suitable for closing large or paper bags.



-HOB-
Customised slicing, packaging and closing machines



Closing conveyor HTA-15S

Features

- ▶ Holly Closing machine type CL for closing with clipband
- ▶ Holly Bagtensioner type HBT to smooth the bag before closing
- ▶ Transportation of the products with pushers on a plastic plate
- ▶ Standard buffer outfeed, free roller conveyor, total length 1000 mm

	various range of unsliced and sliced bread, as well as buns and rolls, packed in a plastic bag (paper on request)
	length : 140 – 400 mm width : 80 – 240 mm height : 70 – 150 mm
	clipband closure with wire thickness 0,6 / 0,7 / 0,8
	60 bags per minute, depending on the products, requirements and the operators working on the machine
	electrical connection 400 Volt – 50 Hz power input ca. 3 kW pneumatic connection 6 bar (10 L/min)



Clipband closing head



Bagtensioner



Optional ▶ Date coder

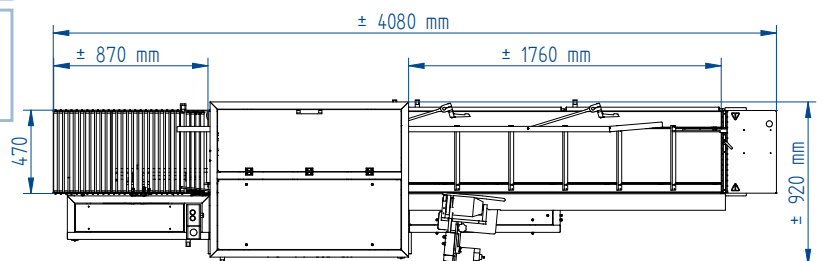

Optional features

- ▶ Holly Bagblower type HBB for manual packing of the products
- ▶ Vacuum pump to remove excess air from the bag
- ▶ Buffer belt instead of passive rollers
- ▶ Extra 500 mm conveyor for the installation of a labelling machine
- ▶ Stainless steel covers and frame
- ▶ Holly Date coder for printing on the closure

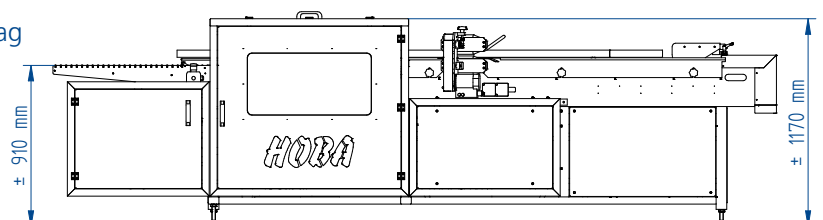

More information?

Mail to info@hoba.ws or call +31 294 411 112